



CE  II 2G c T6

## Low pressure paint spray gun with atomizing air Mod 38

Paint circuit totally in stainless steel compatible with all traffic paint.

### Connections:

- drive air inlet 1/4"
- atomizing air inlet 3/8"
- material inlet 3/8"
- Ø passage of paint 11,5 mm

**Material nozzle in stainless steel:** Ø 3,9 to 6,8 mm

**Special air nozzle in stainless steel:** Ø 5,3 to 8,9 mm

**External nozzles:** a wide choice available in stainless steel, or in tungsten carbide to meet all your needs in performance and width of lines.

The tungsten carbide nozzles have a lifetime much bigger than those in steel (approximately 3 times). The choice of external nozzle will depend on the material nozzle diameter (see the list of nozzles on our website).

One inlet is provided for flushing the head, especially for waterborne traffic paint. The inlet's plug will be replaced by a connection (on request).

It is possible to mount a system with tungsten carbide to limit the width of the line. (Option)

Dimension: 200 x 70 mm

Weight: 2,5 kg

### Advice:

- for the paint using preferably a pipe with a minimum internal diameter of 16 mm
- for air using preferably a pipe with an internal diameter of 10 mm
- for a good performance use an atomizing air pressure below the pressure in the paint tank
- using a drive air pressure of 6 bars (87 psi)

**Kamber SA**  
**Chemin des Champs Courbes 19**  
**CH - 1024 Eculens**

**Tél. +41 (0)21 691 69 51**  
**Fax +41 (0)21 691 69 54**

**e-mail: info@kambersa.ch**

# 38

PISTOLET PNEUMATIQUE PEINTURE POUR LA SIGNALISATION ROUTIERE  
 FARBSPRITZPISTOLE FÜR DIE STRASSENMARKIERUNG  
 PNEUMATIC PAINT SPRAY GUN FOR ROAD MARKING  
 PISTOLA PNEUMATICA PER VERNICI PER LA SEGNALETICA STRADALE  
 PISTOLA NEUMATICA PARA PINTURA PARA LA SENALIZACION VIAL

*Kamber S.A.*

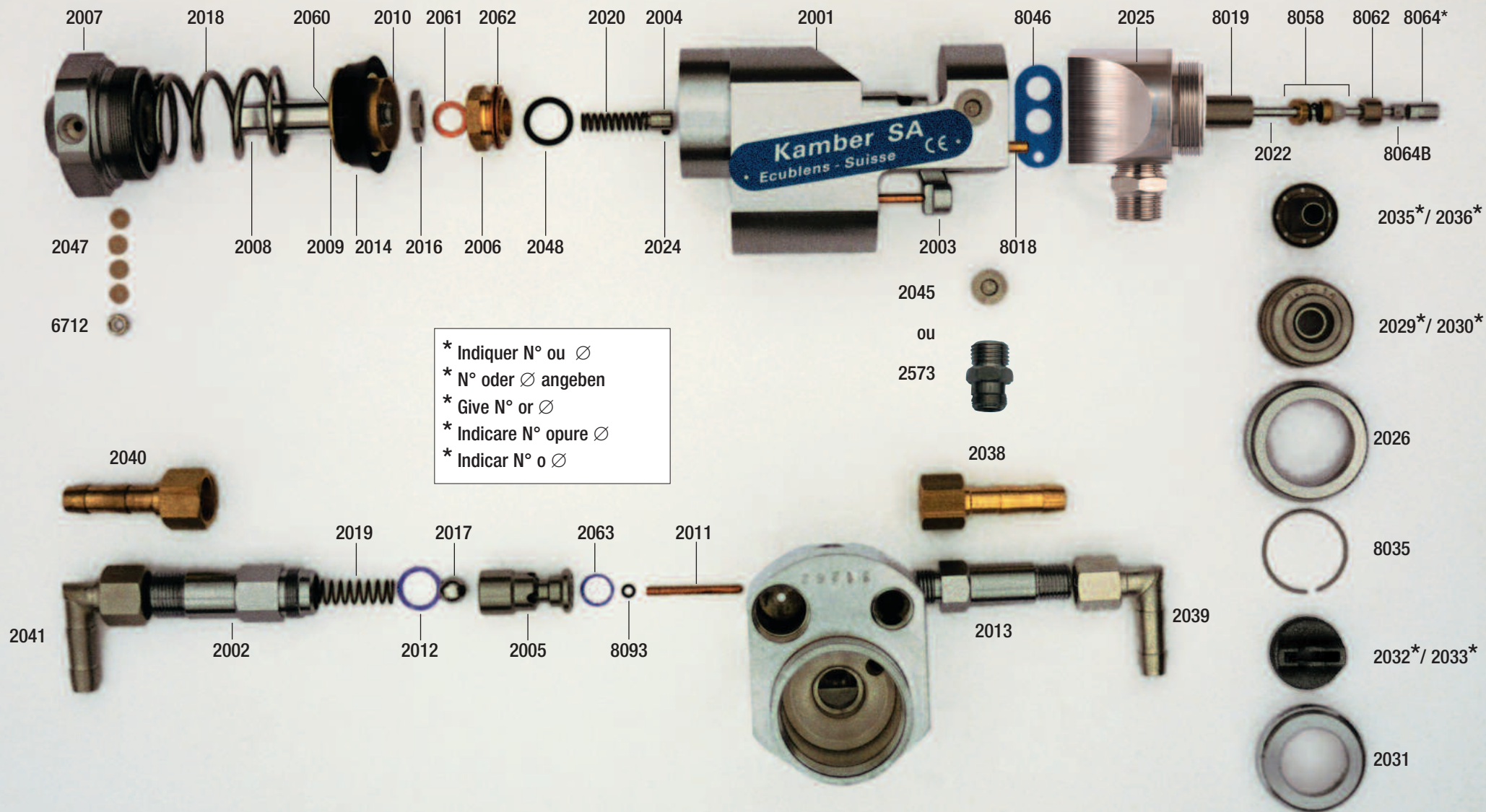

**84** | **38**  
**80** | **90**

ACCESSOIRES POUR PISTOLETS PNEUMATIQUES PEINTURE  
 ZUBEHÖR FÜR PNEUMATISCHE FARBSPRITZPISTOLEN  
 ACCESSORIES FOR PNEUMATIC PAINT SPRAY GUNS  
 ACCESSORI PER PISTOLE PNEUMATICE DA VERNICI  
 ACCESORIOS PARA PISTOLAS NEUMATICAS PINTURA

*Kamber S.A.*



2058 - MD



19058-MD

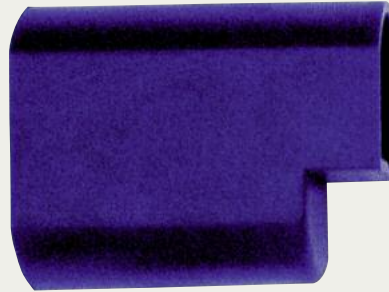

2034

	MOD 84	MOD 38	MOD 80	MOD 90
2028	●	●	●	●
2057	●	●	●	●
2023	●	●	●	
2034		●		
OPTIONS				
2037		●		
7020			●	●
2058-MD	●	●	●	
19058-MD				●

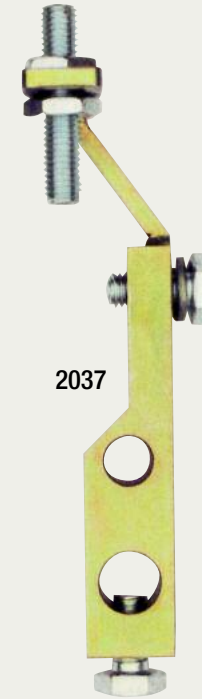

2037



2028



2057



2023

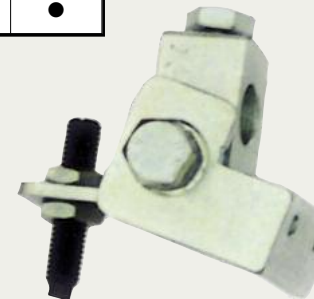

7020



List of nozzles Mod 38 & 80

Set of nozzles		A	B	C	D	E	F
Needle	∅	2.5	3.1	<b>5.0</b>	<b>5.0</b>	<b>6.5</b>	<b>7.5</b>
[Mod 38]		2021A	2021B	2022 + 8064CD		2022 + 8064E	2022 + 8064F
[Mod 80]		7022A	7022B	7022 + 8064CD		7022 + 8064E	7022 + 8064F
Material nozzle	∅	2.2	2.8	<b>3.9</b>	<b>4.5</b>	<b>6.0</b>	<b>6.8</b>
		2035A	2035B	2035C	2035D	2035E	2035F
Basic air nozzle	∅	3.6A	4.2B	<b>5.3C</b>	<b>6.0D</b>	<b>7.45-10 E</b>	<b>8.90-14 F</b>
Carbide = 2029?						<b>7.65-10 E0</b>	
Stainless steel = 2030?						<b>7.65-12 E1</b>	
<b>Cone</b>	∅	<b>10</b>	<b>10</b>	<b>10</b>	<b>10</b>	<b>8.00-12 E2</b>	
						<b>(8.25-12) E3</b>	

					slot width (mm)	spraying width (cm)	application	
External nozzle	N°	1 - <b>1</b>	1 - <b>1</b>		2.0	8 - 12	normal	
Stainless steel = 2032-		2 - <b>2</b>	2 - <b>2</b>		2.0	8 - 18	normal	
<b>Carbide = 2033-</b>		9 - <b>9</b>	9 - <b>9</b>	9 - <b>9</b>	2.0	14 - 25	normal	
				10	2.5	14 - 25	large output	
				11	3.0	10 - 16	large output	
			<b>12- 12</b>	<b>12 - 12</b>	2.5	8 - 18	large output	
			<b>3- 3</b>	<b>3 - 3</b>	2.0	10 - 16	normal	
			<b>4- 4</b>	<b>4 - 4</b>	2.0	14 - 25	normal	
			<b>5- 5</b>	<b>5 - 5</b>	2.0	22 - 40	normal	
			<b>6- 6</b>	<b>6 - 6</b>	2.5	10 - 16	large output	
				<b>7</b>	2.5	18 - 25	large output	
				<b>8</b>	2.5	25 - 40	large output	
				<b>50</b>	2.0	12 - 18	large output	
				<b>51</b>	2.5	12 - 18	large output	
				<b>52</b>	2.0	15 - 25	large output	
					20- <b>20</b>	2.5	10 - 15	large output
					21	2.5	15 - 23	large output
					22	3.0	15 - 23	very large output
					<b>23</b>	2.5	20 - 40	large output
					<b>24</b>	2.5	50	normal
					25- <b>25</b>	3.0	10 - 18	very large output
<b>Cone</b>	∅	<b>10</b>	<b>12</b>	<b>14</b>	<b>27</b>	2.0	20 - 40	large output
External nozzle	N°	1,2,3,4,5,6,7,8,9,10,11,12,50,51	20,21,22,23,24,25,27,28,52	40,41,42,44	<b>28</b>	3.0	20 - 40	very large output
					<b>40</b>	3.0	10 - 16	large output
					<b>41</b>	3.5	10 - 25	very large output
					<b>42</b>	3.8	10 - 25	very large output
					<b>44</b>	3.5	25 - 35	very large output

Example : Gun Mod 38 with set of nozzles E (needle 2022E ∅6.5 - material nozzle 2035E ∅6.0 - basic air nozzle 2031E1 ∅7.65 - 12) and external nozzle **2033-27** or 2032-22