



CE  II 2G c T6

Low pressure paint spray gun with atomizing air Mod 8 HR

Paint circuit totally in stainless steel compatible with all traffic paint.

Connections:

- atomizing air inlet 1/4"
- material inlet 3/8"
- Ø way of paint 8 mm

Material nozzle in stainless steel: Ø 2 to 6,2 mm

Special air nozzle in stainless steel: Ø 4,5 to 7,8 mm

External nozzles: a wide choice available in stainless steel, or in tungsten carbide to meet all your needs in performance and width of lines. The tungsten carbide nozzles have a lifetime much bigger than those in steel (approximately 3 times). The choice of external nozzle will depend on the material nozzle diameter (see the list of nozzles on our website).

It is possible to mount an extension of 400 mm. (Option)

Dimension: 195 x 45 mm

Weight: 1,2 kg

Advice:

- for the paint using preferably a pipe with an internal diameter of 12 mm
- for air using preferably a pipe with an internal diameter of 10 mm
- for a good performance use an atomizing air pressure below the pressure in the paint tank

Kamber SA
Chemin des Champs Courbes 19
CH - 1024 Ecublens

Tél. +41 (0)21 691 69 51
Fax +41 (0)21 691 69 54

e-mail: info@kambersa.ch

8HR

PISTOLET MANUEL PEINTURE A HAUT RENDEMENT SIGNALISATION ROUTIERE
HOCHLEISTUNGS-HANDFARBSPRITZPISTOLE STRASSENMARKIERUNG
MANUAL PAINT SPRAY GUN HIGH OUTPUT FOR ROAD MARKING
PISTOLA MANUALE PER VERNICI PER GRANDE RENDIMENTO SIGNALETICA STRADALE
PISTOLA MANUAL PARA PINTURA GRANDE RENDIMIENTO SENALIZACION VIAL

Kamber S.A.

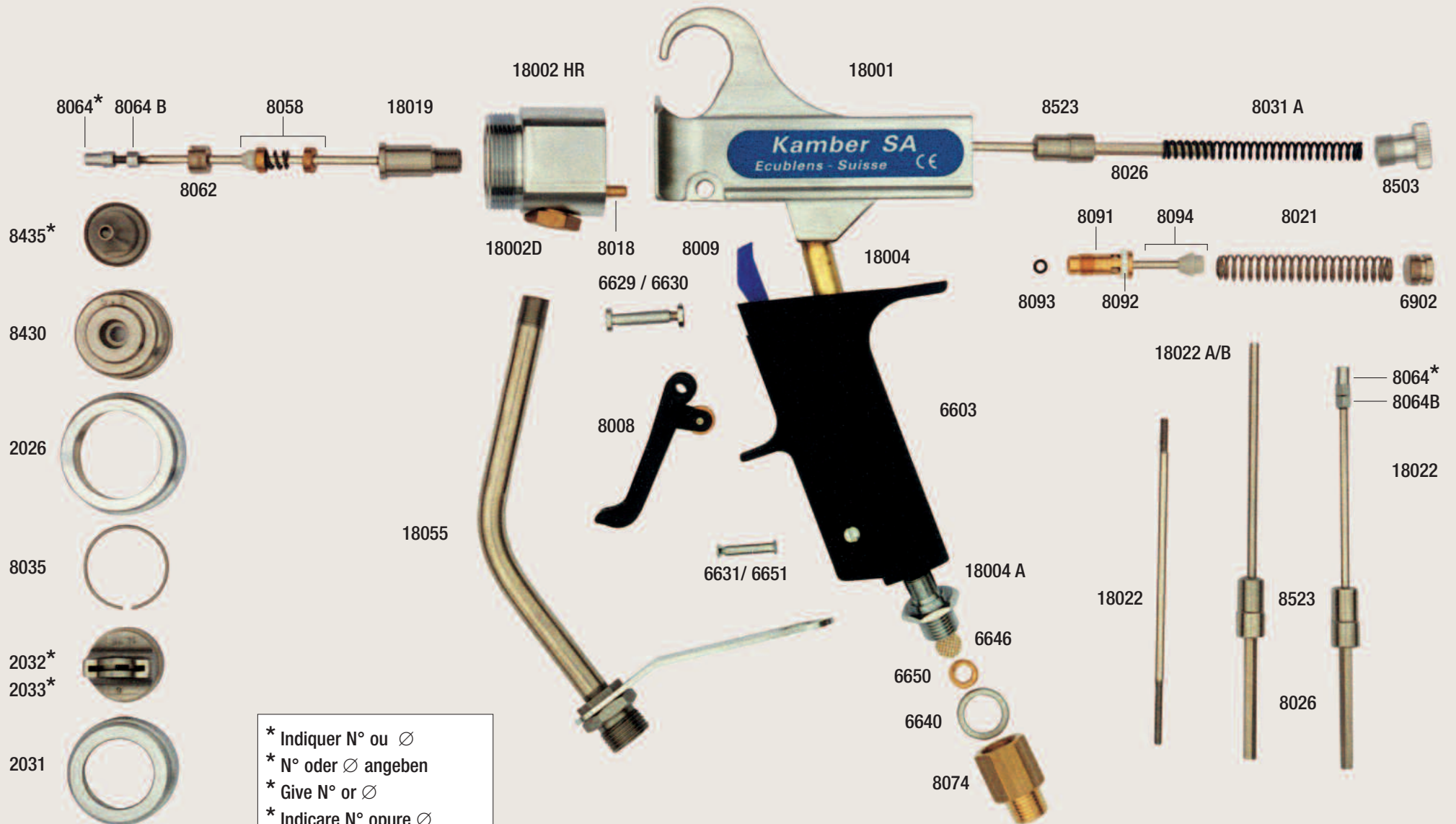

* Indiquer N° ou ∅
* N° oder ∅ angeben
* Give N° or ∅
* Indicare N° oppure ∅
* Indicar N° o ∅

8HR
14HR

RALLONGE 400mm. N°18099 POUR PISTOLET MANUEL PEINTURE
VERLÄNGERUNG 400mm. N°18099 FÜR HANDFARBSPRITZPISTOLE
EXTENSION 400mm. N°18099 FOR MANUAL PAINT SPRAY GUN
PROLUNGA 400mm. N°18099 PER PISTOLA MANUALE PER VERNICI
ANADIDO 400mm. N°18099 PARA PISTOLA MANUAL PARA PINTURA

Kamber S.A.

18099 A



18099 B



18099 C



- * Indiquer N° ou Ø
- * N° oder Ø angeben
- * Give N° or Ø
- * Indicare N° oppure Ø
- * Indicar N° o Ø



List of nozzles Mod 8HR & 14HR

Nozzles set		A	B	C	D	E	F			
Needle	∅	3.5	3.5	5.0	5.0	6.5	6.5			
		18022AB		18022 + 8064CD		18022 + 8064E				
Material nozzle	∅	2.0	3.0	3.5	4.0	5.0	6.2			
		8435A	8435B	8435C	8435D	8435E	8435F			
Basic air nozzle	∅	4.5	4.5	5.5	5.5	7.8	7.8			
		8430AB		8430CD		8430EF		slot width (mm)	spraying width (cm)	application
External nozzle	No	3 – 3	3 – 3	3 – 3	3 – 3	3 – 3	3 – 3	2.0	10 – 16	standard
Stainl. Steel = 2032-		4 – 4	4 – 4	4 – 4	4 – 4	4 – 4	4 – 4	2.0	14 – 25	standard
Carbide = 2033-		5 – 5	5 – 5	5 – 5	5 – 5	5 – 5	5 – 5	2.0	20 – 40	standard
		6 – 6	6 – 6	6 – 6	6 – 6	6 – 6	6 – 6	2.5	10 – 16	large output
		9 – 9	9 – 9	9 – 9	9 – 9	9 – 9	9 – 9	2.0	14 – 25	standard
		12 – 12	12 – 12	12 – 12	12 – 12	12 – 12	12 – 12	2.5	8 – 18	large output
		20 – 20	20 – 20	20 – 20	20 – 20	20 – 20	20 – 20	2.5	10 – 15	large output
		23	23	23	23	23	23	2.5	20 – 40	large output
		27	27	27	27	27	27	2.0	20 – 40	large output
		28	28	28	28	28	28	3.0	20 – 40	very large output
		50	50	50	50	50	50	2.0	12 – 18	large output
		51	51	51	51	51	51	2.5	12 – 18	large output
		52	52	52	52	52	52	2.0	15 – 25	large output

Example : Gun Mod 8 HR and 14 HR with set of nozzles D (needle 8064CD ∅5.0 - material nozzle 8435D ∅4.0 - basic air nozzle 8430CD ∅5.5) and external nozzle 2033-20 or 2032-20